

wedi benches and niches

plus fastening technology

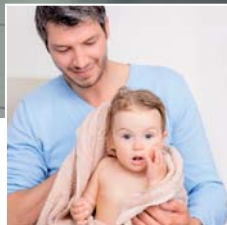

NEW

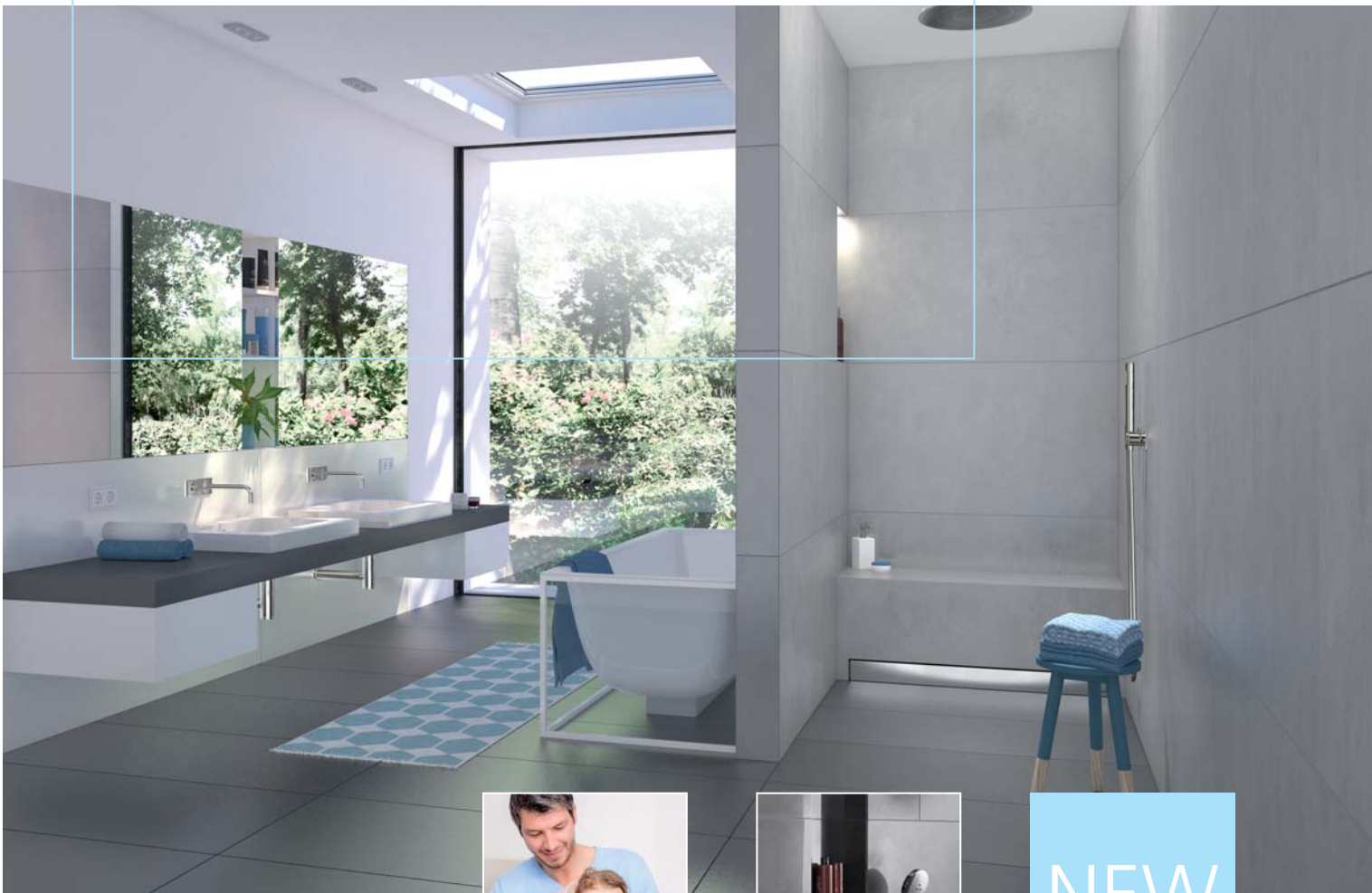

The possibilities are endless.

Benches and niches for maximum comfort

Spacious seating areas for relaxation with plenty of storage space for all your shower components – how would you like to redesign your own bathroom into an oasis of well-being? With the new shower bench designs and niche solutions by wedi, your dream of having your own small wellness temple can become a reality. The elegant styling and modern lines of wedi innovations creates an inviting atmosphere of well-being where you can relax and forget about the stresses of daily life. **The wide range of design opportunities will give your bathroom a personal touch.**

NEW ■ wedi Sanoasa corner seat element



NEW ■ wedi Niches



NEW ■ wedi Sanoasa benches

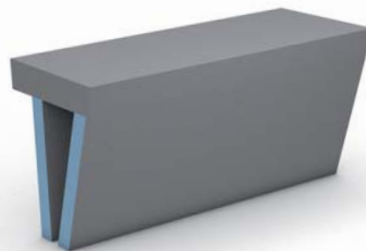



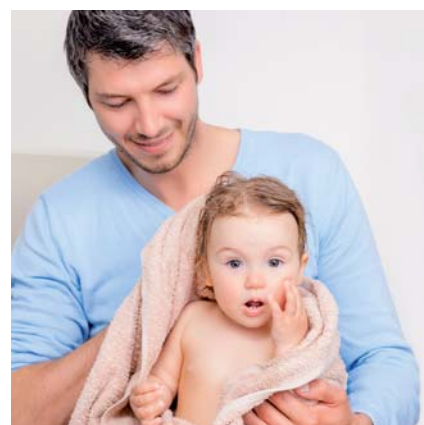



System configuration for shower solution systems with benches

Products used

- [1] [wedi Fundo Riolito neo](#) ▪ the flush to floor shower element with close-to-wall linear drainage
- [2] **NEW:** [wedi Sanoasa bench 1](#) ▪ bench, straight
- [3] [wedi Fundo Riolito Discreto](#) ▪ the visual wall drain, in this case, integrated in the carrier element of the bench
- [4] [wedi building boards](#) ▪ as free-standing partition wall and for the cladding of wall surfaces
- [5] **NEW:** [wedi Nonstep Pro](#) ▪ sound insulation mats for water impact insulation underneath wedi Fundo floor units
- [6] **NEW:** [wedi border Insulating strips](#) ▪ sound protection and insulation for the area between wedi Fundo floor units and walls
- [7] [wedi 610](#) ▪ adhesive and sealing material for waterproof bonding of joints as well as for installation

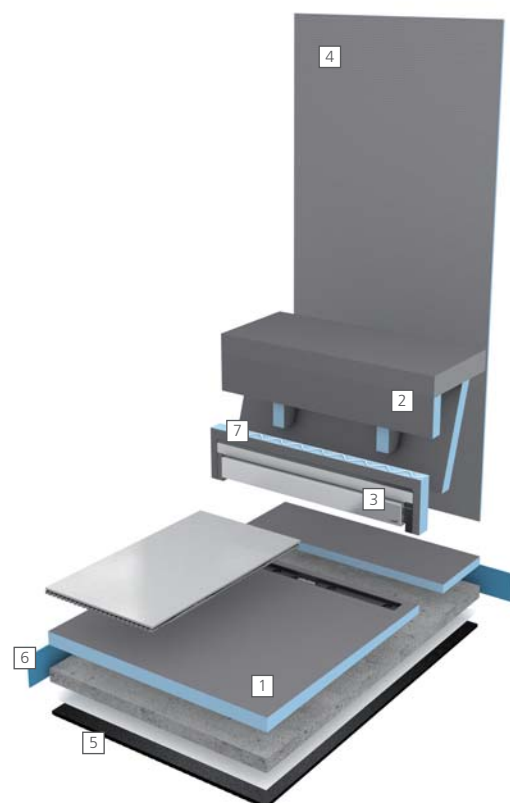

Construction variations of the wedi Sanoasa bench 1 – 3

The clever construction of the wedi Sanoasa bench enables unequalled freedom of visual design. That way, both the seating areas and the carrier elements can be positioned the way you like and their shapes and sizes can be modified.

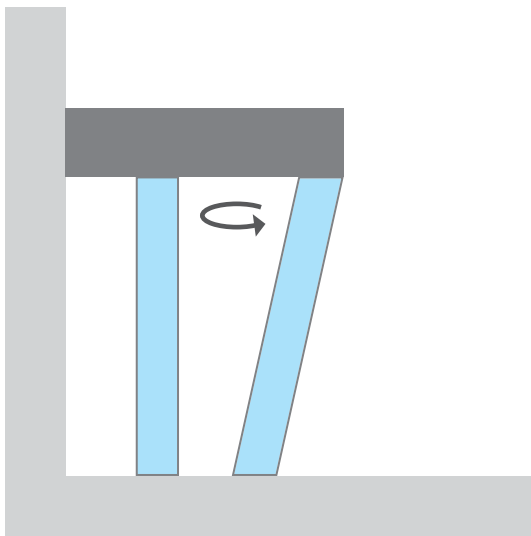

Base can be positioned freely

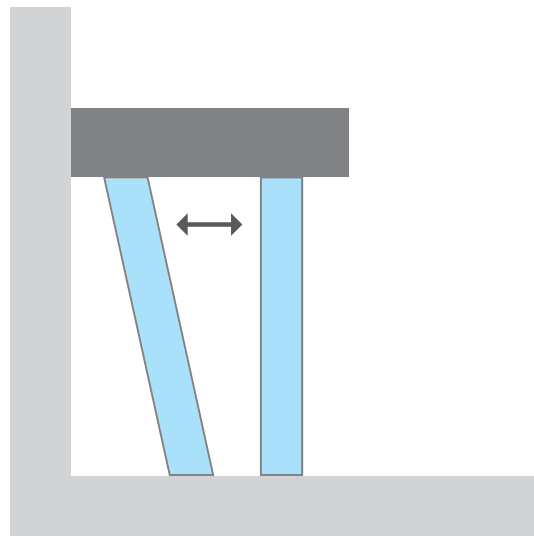

Seating area can be shortened for different configurations

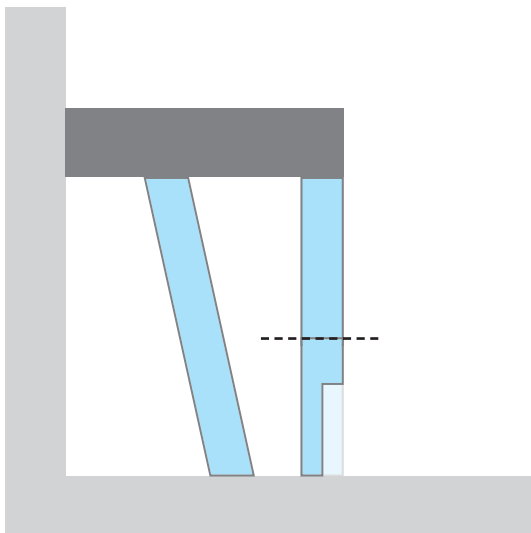

1-cut Discreto Montage The front element can be modified for integration of the Fundo Riolito Discreto wall drain

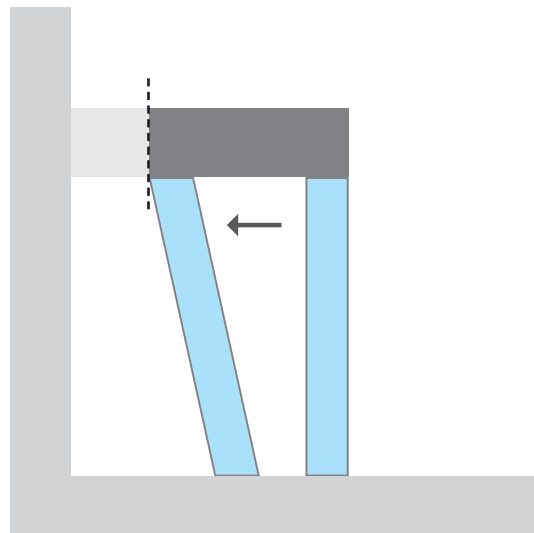

Seating can be shortened to different variations



System configuration for niche solutions

Products used

- 1 **NEW:** [wedi niche](#) ■ for additional storage space in the shower and bathroom
- 2 [wedi building boards](#) ■ for designing wall and niche solutions
- 3 [wedi 610](#) ■ adhesive and sealing material for waterproof bonding of joints as well as for installation
- 4 [wedi Tools reinforcement tape](#) ■ for reinforcing joints

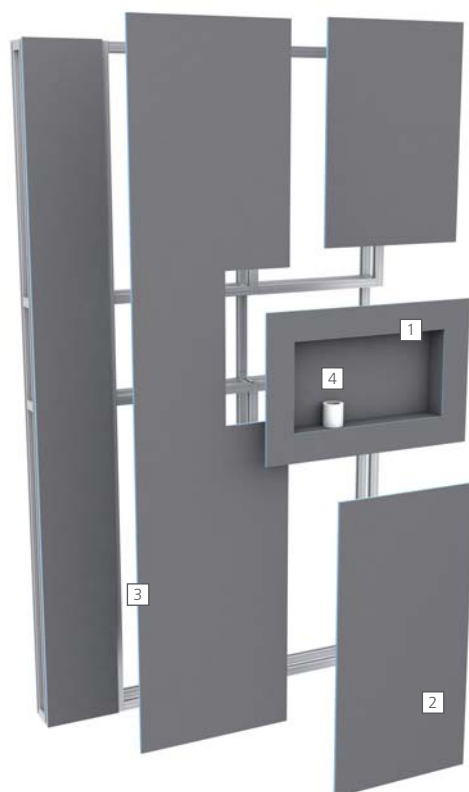

B

System configuration for shower solution systems with corner seats

Products used

- 1 **NEW:** wedi Sanoasa corner seat ▪ space-saving seating
- 2 wedi building boards ▪ for cladding wall, floor and ceiling surfaces and for creating niche solutions
- 3 wedi 610 ▪ adhesive and sealing material for waterproof bonding of joints as well as for installation
- 4 wedi Tools reinforcement tape ▪ for reinforcing joints

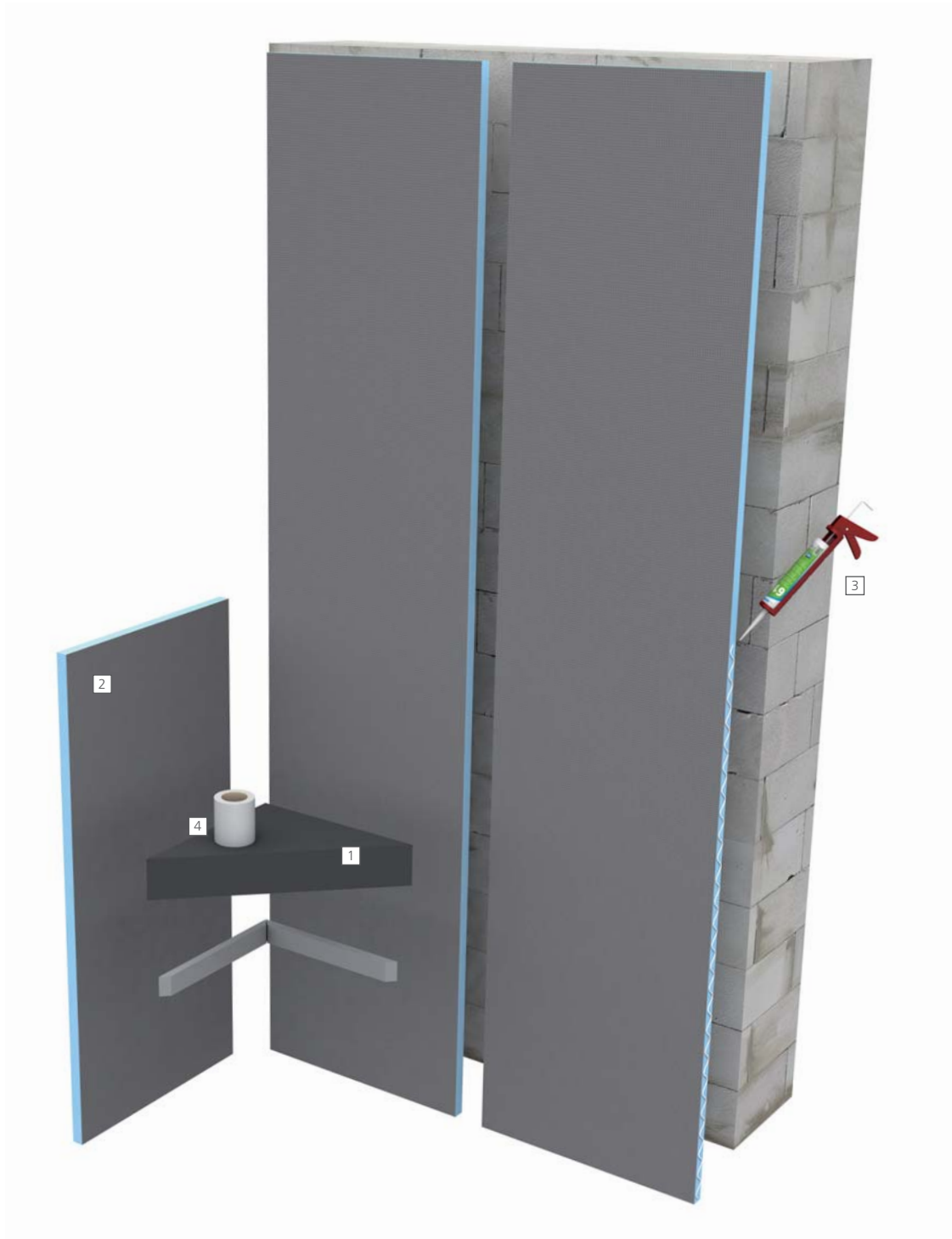



02

03

04



We only use the best materials for the best systems

01 Waterproof

The blue XPS core is 100 % waterproof and still functions if it becomes damaged.

02 Stable

The cement-coated surface forms an incredibly strong and stable base for adhesive thanks to the integrated fabric.

03 Heat insulating

All of our building board systems provide fantastic insulation, save energy costs and provide long term protection against mould and fungus.

04 abP*, CE, VOC, ETA

These approvals verify that wedi products are tested sealing systems for wet rooms, and due to their A+ labelling, they also indicate their non-hazardous and low-emissions design – according to both German as well as European regulations and laws.

For maximum safety with shorter installation times, simply use wedi 610 for the watertight sealing of the butt joints of the basic wedi building board material. Along with the joint reinforcement tape.

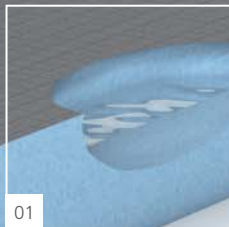

* abP (Allgemeines bauaufsichtliches Prüfzeugnis)
German General Building Inspection Certificate for tile
and board coverings, also in areas which bear heavy loads

wedi Sanoasa benches 1 – 3

Comfort means something different to each person. The feeling of quiet and relaxation when sitting in the shower, though, is a very pleasant experience for everyone. wedi Sanoasa benches provide plenty of space to relax and pamper your body in comfort.

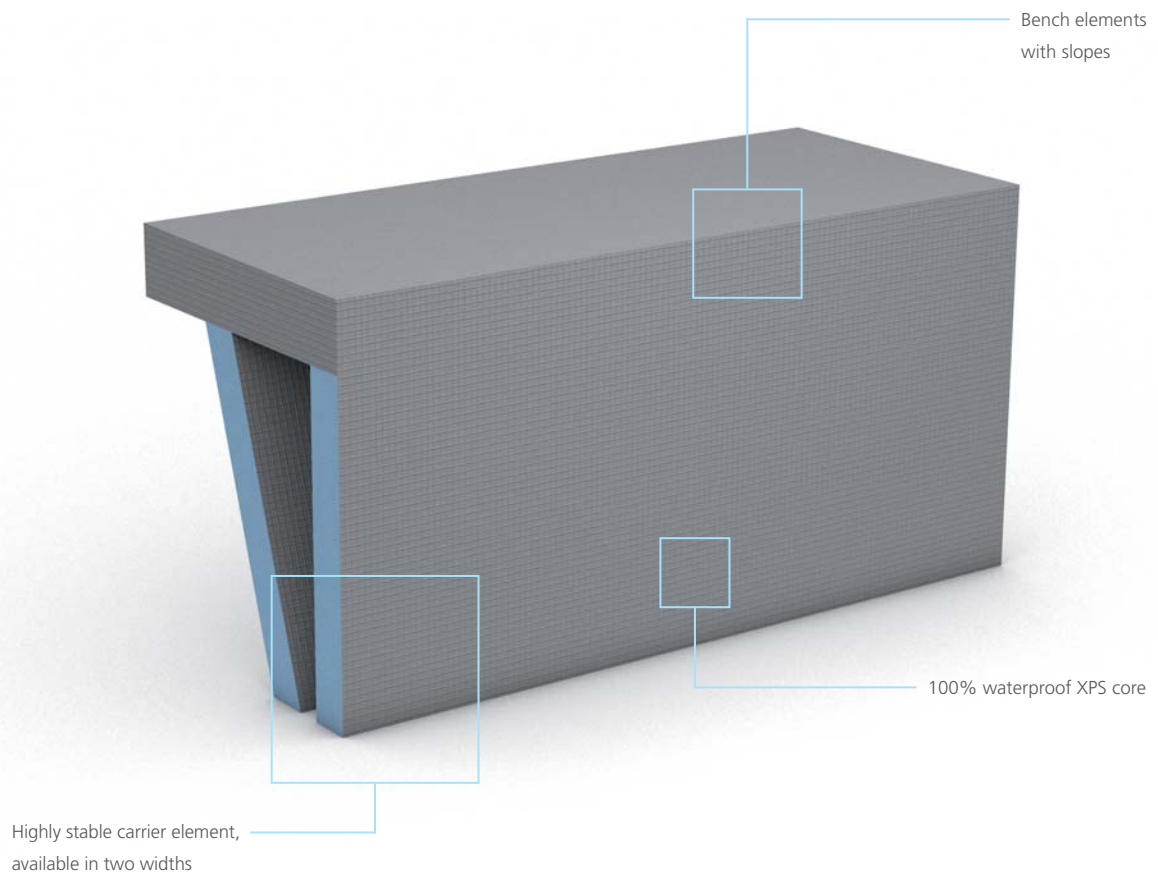

wedi Sanoasa corner seat

Fine detail with a strong impact. The new corner seat in a pure triangular shape is available in two sizes and invites you to a relaxing wellness break in the shower.

Very strong: handles
loads up to 150 kg

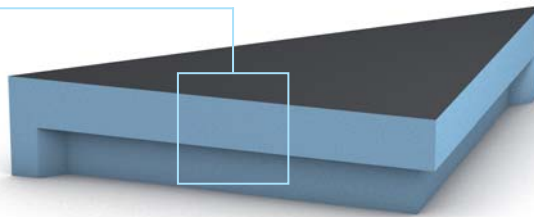

wedi niches

wedi niche solutions are practical but at the same time aesthetically pleasing. Their spacious design highlights their luxurious character in the bathroom and also provides convenient shelf space. Particularly in small guest bathrooms, they offer extra space for a variety of shower components or personal decorative touches.

100% waterproof XPS core

Easily integrated in the
wedi standard range

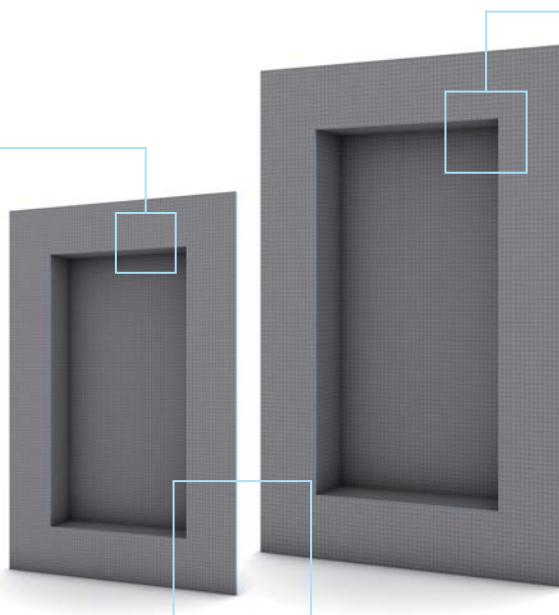

Different sizes

wedi cavity dowels set

Everything you need for fixing once the tiling is complete. With the cavity dowel set, bathroom accessories such as mirrors, soap dispensers and towel rails can be attached quickly and easily.

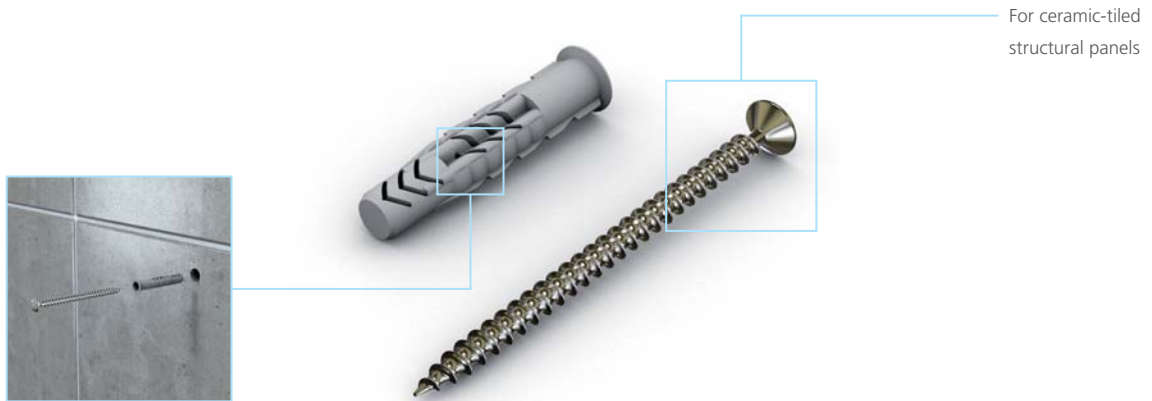

wedi fixings set

For a secure hold underneath the tiles. Heavy objects, such as fittings and glass doors, can be attached securely with the mounting set. Depending on the load, the larger or smaller reinforcing plate contained in the set can be used. The plate is easily integrated into a suitable recess in the wedi structural panel with wedi 610 adhesive sealant.

Stable composite material
in two sizes

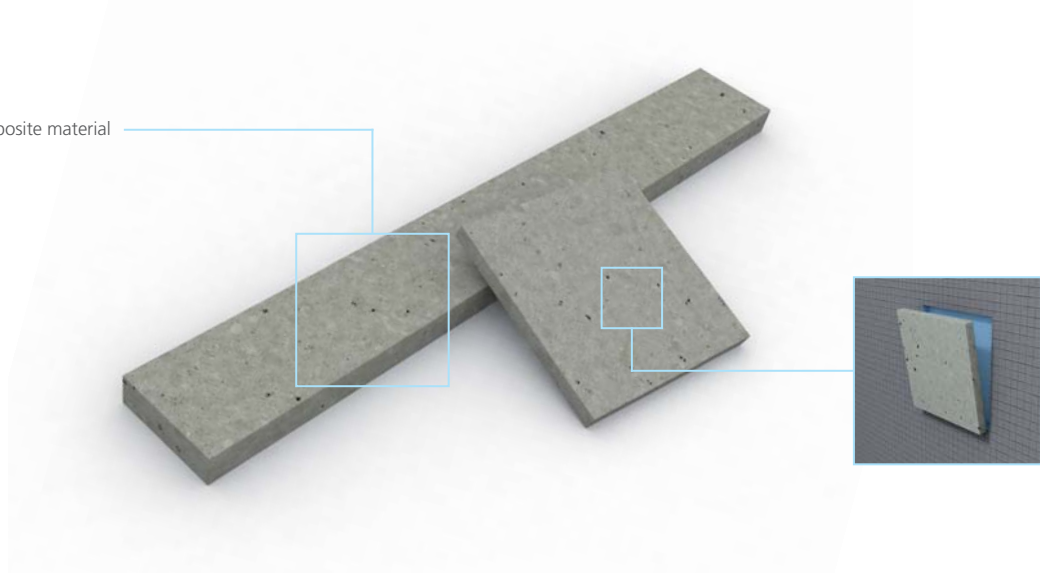

wedi Sanoasa benches

	Description	Length × Depth × Height	Packing unit	Order no.
	wedi Sanoasa bench 1, straight	900 × 380 × 454 mm	1 unit	07-64-47/020
	wedi Sanoasa bench 1, straight	1200 × 380 × 454 mm	1 unit	07-64-47/021
	wedi Sanoasa bench 2, angled	900 × 380 × 454 mm	1 unit	07-64-47/022
	wedi Sanoasa bench 2, angled	1200 × 380 × 454 mm	1 unit	07-64-47/023
	wedi Sanoasa bench 3, rounded	900 × 380 × 454 mm	1 unit	07-64-47/024
	wedi Sanoasa bench 3, rounded	1200 × 380 × 454 mm	1 unit	07-64-47/025

wedi Sanoasa corner seat element

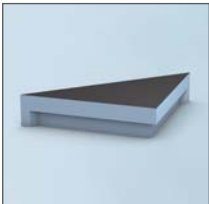
	Description	Length × Depth × Height	Packing unit	Order no.
	wedi Sanoasa corner seat element, size M	600 × 300 × 100 mm	1 unit	07-37-84/302
	wedi Sanoasa corner seat element, size L	800 × 400 × 100 mm	1 unit	07-37-84/402

wedi Niches

	Description	Interior dimensions: Width × Height	Packing unit	Order no.
	wedi Niche, rectangular	200 × 400 mm	1 unit	07-43-15/410
	wedi Niche, rectangular	300 × 600 mm	1 unit	07-43-15/411

wedi Tools ■ cavity dowels set

	Description	Diameter × Length	Packing unit	Order no.
	wedi Tools, cavity dowels set, 10 dowels and 10 screws	screw: Ø 4,5 × 60 mm dowel: Ø 6,0 × 35 mm	1 Sachet	20-65-53/004

wedi Tools ■ fixings set

	Description	Length × Width × Thickness	Number / set	Order no.
	wedi Tools, fixings set, composite material	400 × 50 × 15 mm 100 × 100 × 8 mm	2 units 12 units	20-65-53/001

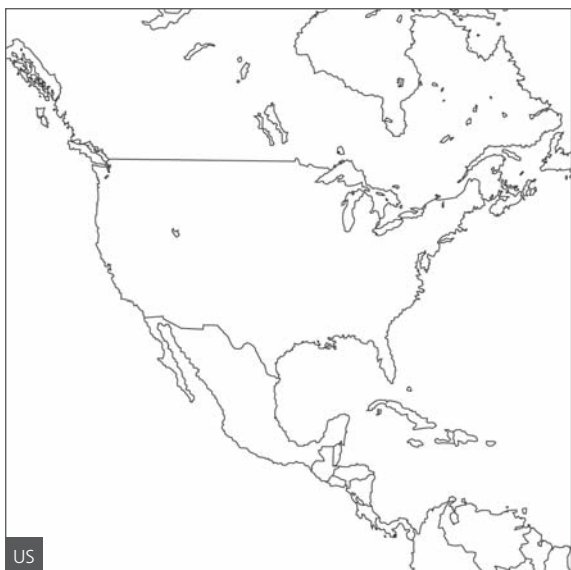

- Australia
- Austria
- Belgium
- Bosnia Herzegovina
- Canada
- Croatia
- Czech Republic

- Denmark
- Estonia
- Finland
- France
- Germany
- Great Britain
- Greece

- Hungary
- Iceland
- Ireland
- Italy
- Latvia
- Lithuania
- Luxembourg

- Netherlands
- Norway
- Poland
- Portugal
- Romania
- Russia
- Serbia

- Slovenia
- Spain
- Sweden
- Switzerland
- Turkey
- Ukraine
- USA



wedi GmbH

Hollefeldstraße 51
48282 Emsdetten
Germany

Telephone +49 25 72 156-0
Fax +49 25 72 156-133

info@wedi.de
www.wedi.eu

wedi Systems (UK) Ltd

Unit 4 Mercury Park · Mercury Way
Trafford Park · M41 7LY
Great Britain

Telephone +44 161 864 2336
Fax +44 161 864 1323

info@wedi.co.uk
www.wedi.co.uk

